



Castles

SEYMOUR ROAD
Northchurch, HP4 3RQ

SEYMOUR ROAD

Northchurch, HP4 3RQ

£400,000
(Freehold)



We are delighted to present this charming two-bedroom mid-terraced cottage, now available for sale. Nestled on a peaceful residential road in the sought-after area of Northchurch, this property offers a perfect blend of comfort and convenience. As you step inside, you will be greeted by a cozy lounge that provides a warm and inviting space to relax and unwind. The well-appointed kitchen is designed to cater to your culinary needs, offering ample storage and countertop space for meal preparation. Upstairs, the property boasts two generously sized bedrooms, each filled with natural light and offering a tranquil retreat at the end of the day. The modern bathroom suite is tastefully finished, providing a comfortable space to refresh and rejuvenate. One of the standout features of this home is the private rear garden, an ideal spot for outdoor entertaining, gardening, or simply enjoying some quiet time in the fresh air. The cottage is ideally located within close proximity to local amenities, including shops, schools, and public transport links, making it a convenient choice for those seeking easy access to daily necessities.

Tenure: Freehold
Council Tax Band: C
EPC Rating: D

Ground Floor

Approx. 21.0 sq. metres (225.6 sq. feet)

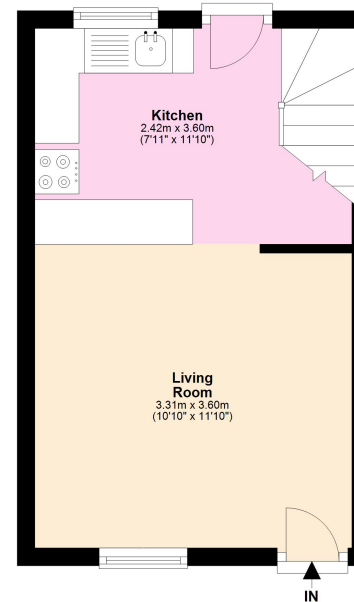

First Floor

Approx. 22.3 sq. metres (240.4 sq. feet)

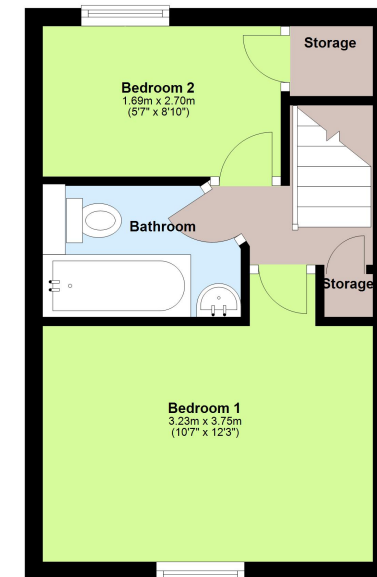

Total area: approx. 43.3 sq. metres (466.0 sq. feet)

This floorplan is not to scale. It's for guidance only and accuracy is not guaranteed.
Plan produced using PlanUp.

Please Note:

We have not tested any apparatus, fixtures, fittings or services. Interested parties must undertake their own investigation into the working order of these items.

All measurements are approximate and photographs provided are for guidance only.

Berkhamsted Office: 148 High Street, Berkhamsted, Hertfordshire HP4 3AT **Tel: 01442 865252**
Boxmoor Office: 33 St John's Road, Hemel Hempstead, Hertfordshire HP1 1QQ **Tel: 01442 233345**
Eaton Bray Office: 2a Wallace Drive, Eaton Bray, Dunstable LU6 2DF **Tel: 01525 220605**
Kings Langley Office: 1 High Street, Kings Langley, Hertfordshire WD4 8AB **Tel: 01923 936900**
Associated London Office: 121 Park Lane, Mayfair, London W1K 7QG **Tel: 020 7079 1595**

www.castlestateagents.co.uk



Castles