



Castles

CORAL CLOSE
Eaton Bray, Bedfordshire

CORAL CLOSE

Eaton Bray, Bedfordshire

Tenure: Leasehold
Council Tax Band: C
EPC Rating: D

Asking Price £275,000

(Leasehold)



Tucked away in a fantastic position at the end of a cul de sac this 2 bedroom, ground floor maisonette offers the unusual benefits of a private garden and garage for a property of this size. The accommodation comprises 2 bedrooms, nice size kitchen, lounge diner, conservatory and bathroom. Externally the well presented garden, garage and parking offers a huge benefit.

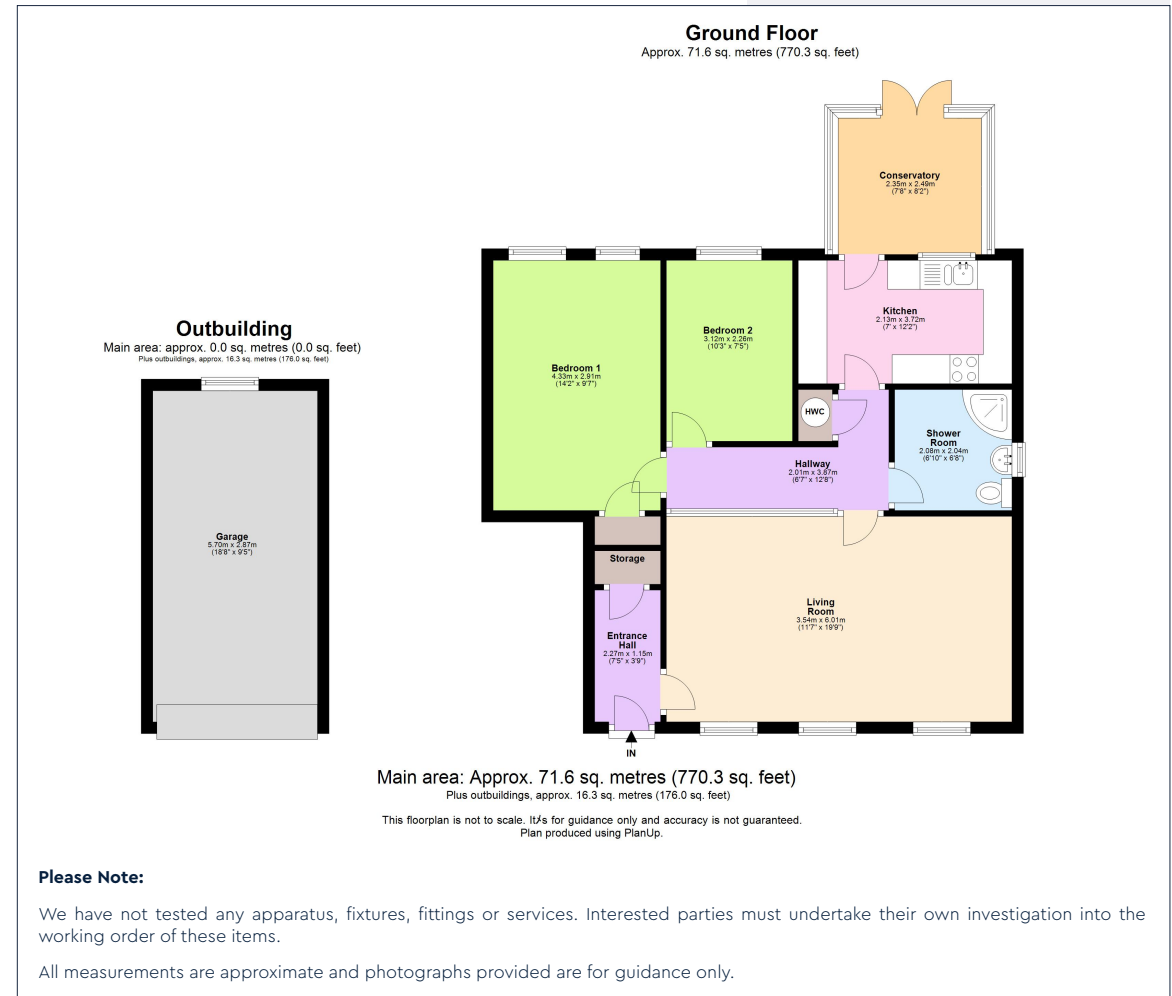

Berkhamsted Office: 148 High Street, Berkhamsted, Hertfordshire HP4 3AT **Tel: 01442 865252**
Boxmoor Office: 33 St John's Road, Hemel Hempstead, Hertfordshire HP1 1QQ **Tel: 01442 233345**
Eaton Bray Office: 2a Wallace Drive, Eaton Bray, Dunstable LU6 2DF **Tel: 01525 220605**
Kings Langley Office: 1 High Street, Kings Langley, Hertfordshire WD4 8AB **Tel: 01923 936900**
Associated London Office: 121 Park Lane, Mayfair, London W1K 7QG **Tel: 020 7079 1595**

www.castlestateagents.co.uk



Castles